



APPLICATION INSTRUCTIONS

SELF-ADHESIVE WATERPROOFING MEMBRANE

GRIPGARD

USES :

- For new roofing and reroofing with tear-off ;
- Seals against water damage from ice dams and wind driven rain ;
- Ideal protection on eaves, in valleys, along ridges, around chimneys, windows and skylights, at roof perimeters (rake edge) and as joint flashings ;
- For maximum protection, GRIPGARD can be applied over the whole roof deck.

STORAGE :

- Store inside or under cover ;
- Avoid storage over 32°C (90°F) ;
- Stand upright.

SURFACE PREPARATION :

- **New Construction :** Deck must be dry and frost-free. All dirt, dust and protrusions must be removed ;
- **Reroofing :** Remove all shingles, felts, nails and metal from roof deck area. Deck must be dry and frost-free. All dirt, dust and protrusions must be removed.

PRECAUTIONS :

- Always apply GRIPGARD directly to the wood deck. Do not apply over shingles, felt or insulation ;
- Do not leave exposed to the sun for more than seven days ;
- Use on dry decks when air and surface temperatures are over 4°C (40°F) ;

- The space under the roof deck must be properly ventilated ;
- The roof can be a dangerous place to work. Ensure that you are fastened safely at all times. Do not walk on GRIPGARD when wet or covered with frost.

INSTALLATION :

Eaves :

- 1] Unroll GRIPGARD on 2 m (6 ft.) ;
- 2] Align this material along the edge of the roof and reroll ;
- 3] Peel back about 30.5 cm (12") of release film backing and bring this portion of the film under the roll. Adhere the peeled area and center one nail. Reroll to the adhered portion ;
- 4] Pull on the release film backing to unroll GRIPGARD and press the material into place to ensure tight bond. If the membrane deviates from the roof line, cut and start as above mentioned procedure ensuring there will be a 15.2 cm (6") side lap* ;
- 5] Starting at the low point of the roof, work upward. Apply GRIPGARD by laying the roll horizontally and extending up the roof, from the eaves, to a point at least 30.5 cm (12") beyond the interior wall line. On low slope roofs (2-4 in/ft. or 2/12 to 4/12) GRIPGARD must be extended a minimum of 61 cm (24") beyond the inside surface of the exterior wall. This requirement may vary depending on location. Check your local building code for minimum requirements ;
- 6] End and side laps* must be a minimum of 15.2 cm (6") ;
- 7] For multiple courses overlap product by 50 mm (2").

* All end laps must be sealed down with a 10cm (4") wide, thin and uniform layer of plastic cement.



GRIPGARD

Roof Perimeter (rake edge) :

- 1] Apply as on eaves, aligning material along the edge of the roof ;
- 2] On slopes, always start at the low point of the roof and work upwards ;
- 3] Only one width of GRIPGARD is required for perimeter protection ;
- 4] End laps must be a minimum of 15.2 cm (6") and all end laps must be sealed down with a 10 cm (4") wide, thin and uniform layer of Asphalt Plastic Cement.

Valleys, Hips and Ridges :

- 1] Cut GRIPGARD into required lengths ;
- 2] Fold GRIPGARD in its center and align it with the center of the valley, hip or ridge ;
- 3] Peel back 30.5 cm (12") of one section of the release film backing and bring this portion of the film under the roll. Adhere the peeled area and center one nail. Reroll to the adhered portion ;
- 4] Pull on the release film backing to unroll GRIPGARD and press the material into place to ensure tight bond ;
- 5] Peel back the second half of the release film backing and press firmly to complete the work.

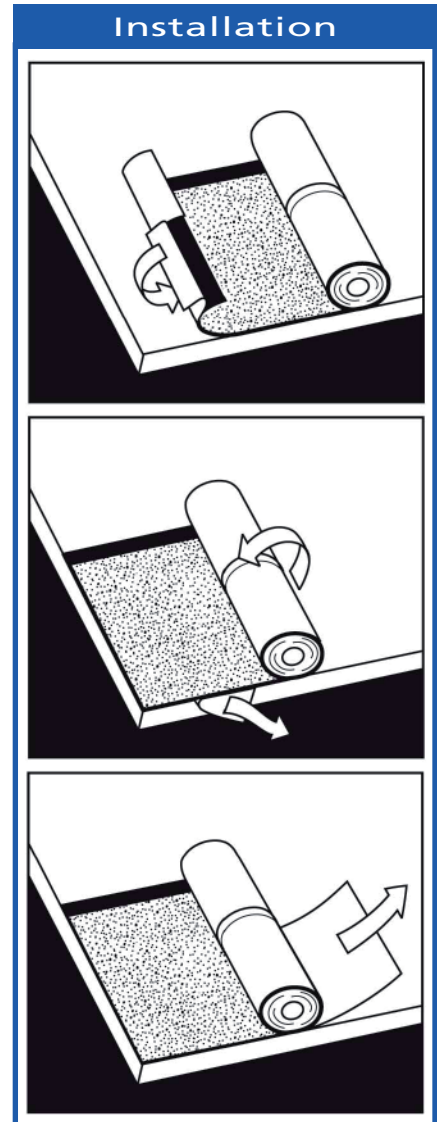

Building Products of Canada Corp.

To obtain the most recent version of this document, please visit our website at www.bpcan.com